



2D LINKAGES

Manual adding of linkages to entities

Check the entities, which you want to add the linkage. After the checking Property Manager will be opened (with the automatic choice of appropriate linkages). Checked entities will be marked in **Chosen entities** bookmark.

Click LTM required linkage form bookmark **Add linkages**. The linkage will be added and entity will assume required position. Added linkage will be marked in **Existent linkages** bookmark. Tick the added linkage by green tick sign.

Linkages can be added in context menu, where you can find topical choice in the first line.



Linkage cancellation

Tick (in Property Manager) the undesirable linkage in **Existent linkages** bookmark and push **Delete**.

Intelligent dimension command

Added dimension makes the linkage of chosen entity – define its size.

Command **Intelligent dimension** is adaptable. It creates horizontal, vertical and angular dimensions, dimensions of diameters and radiuses not only by your checked entities but according to the position of cursor.

Modification of dimension

If you want to change the value of dimension, edit it by double click LTM, rewrite the size in opened window **Modify** and validate it.

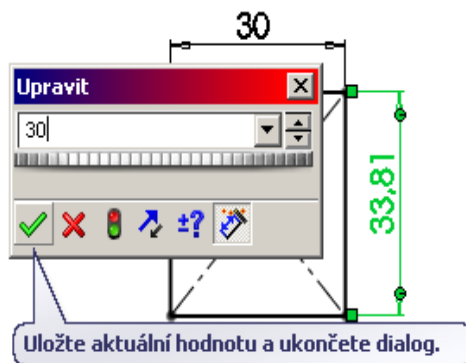
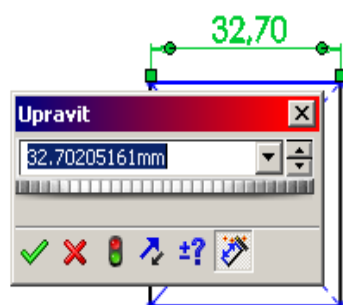
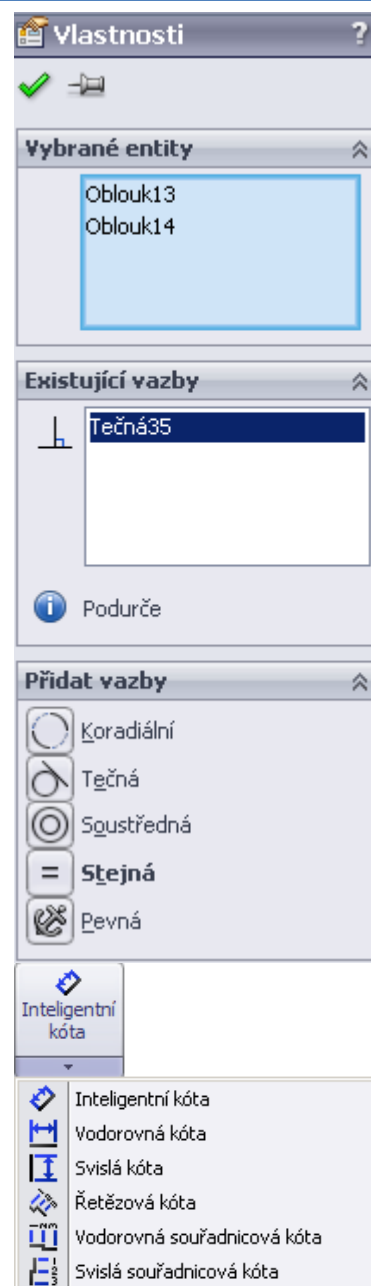

EXERCISES



Draw simple 2D sketches by the model and add labeled linkages to entities.

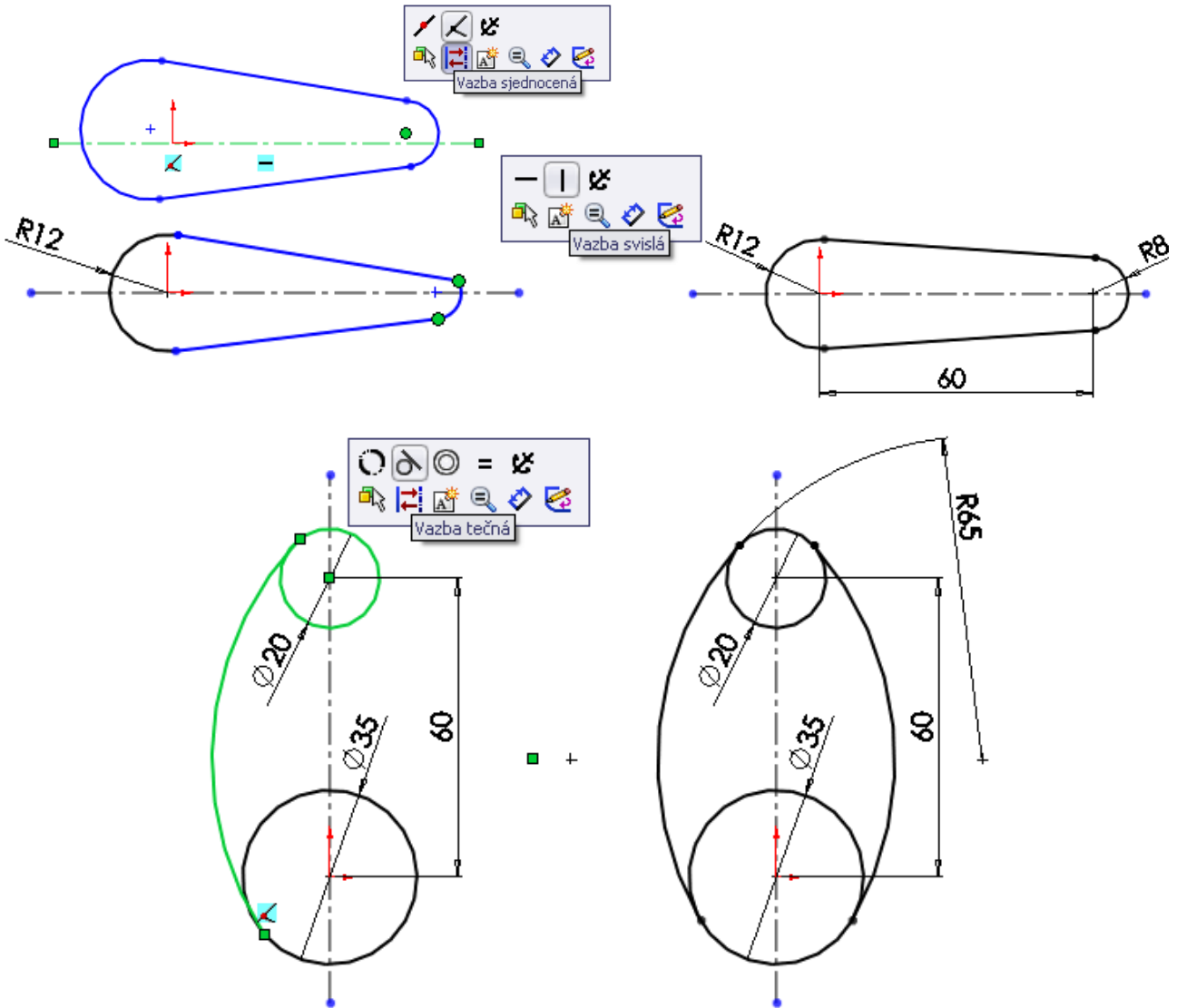

By adding linkage (**the same**) is from dimensioned circle with diameter

of 25 mm made controlled entity. By its change the sizes of other (controlled) entities are changed.

